

XY-HG型治标液压缸

型号说明

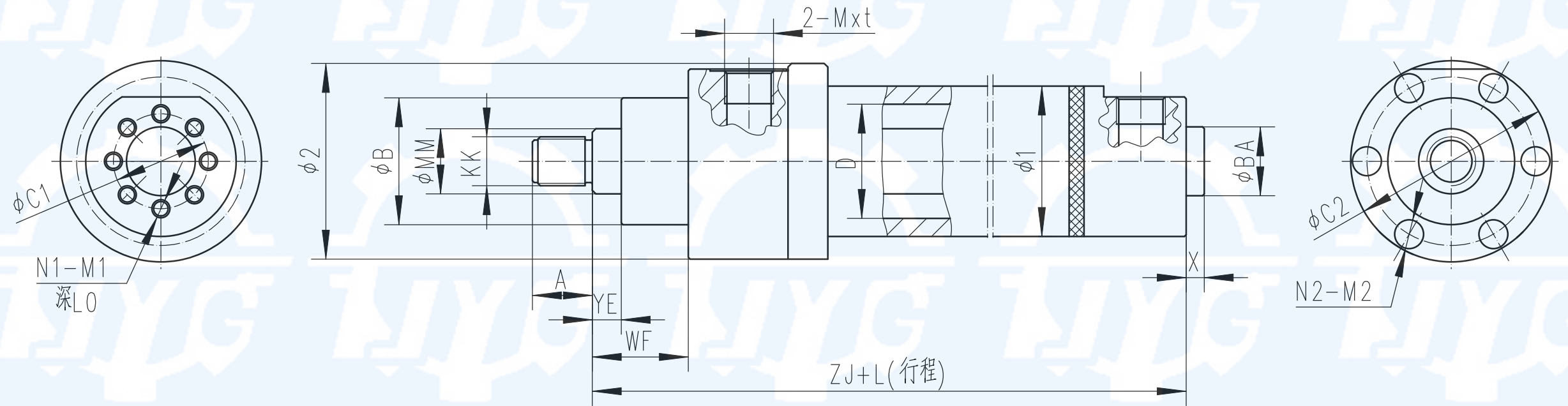

基本型安装连接尺寸图表



头部长方法兰安装连接尺寸

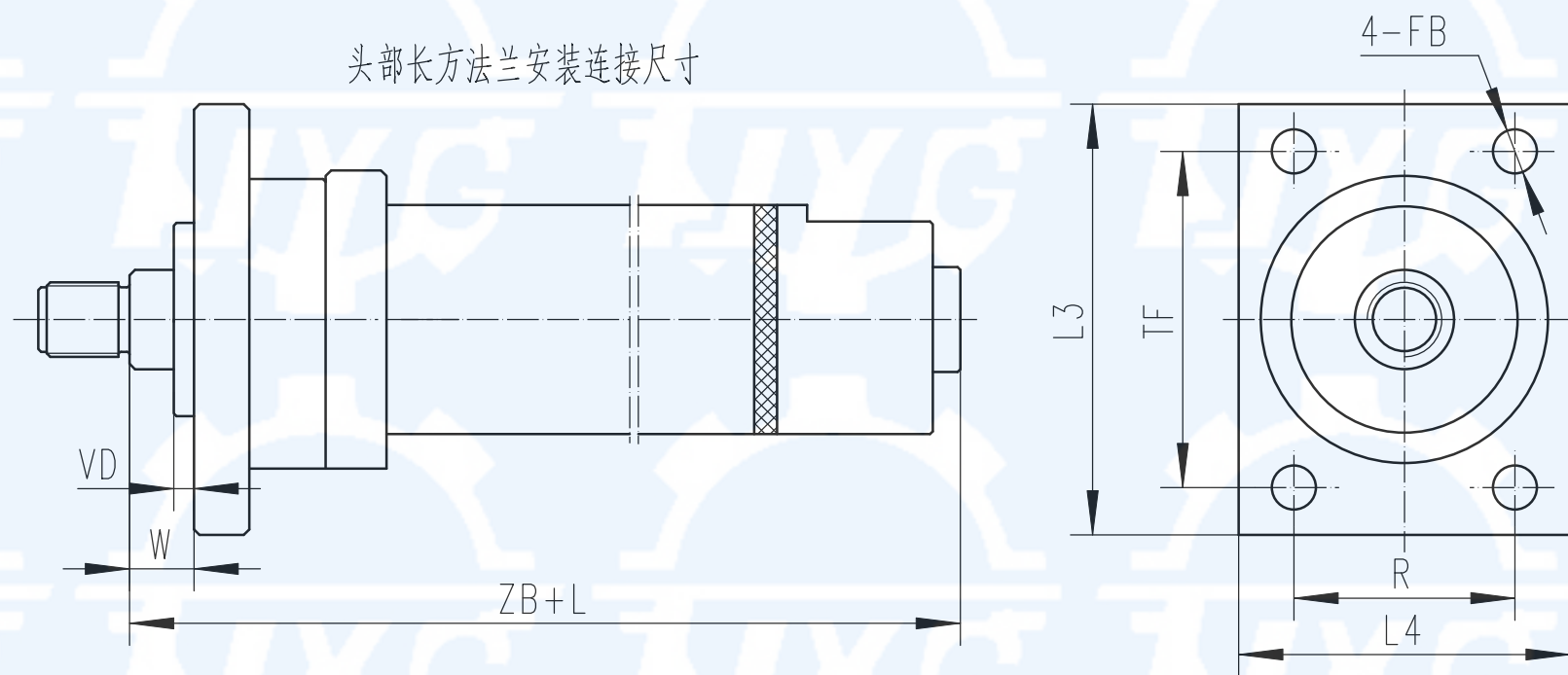

小冶精通（天津）液压机械有限公司

表5

| 缸径 σ | 速比 ψ | 杆径 ϕ mm | 推力 P1(kg) | 拉力 P1(kg) | KK | A | Mxt | Φ B | Φ BA | Φ C ₁ | Φ C ₂ | Φ ₁ | Φ ₂ | VE | WF | ZJ | X | L | n ₁ -M ₁ | n ₂ -M ₂ | 重量 kg(1= σ) | L每增加10mm重 量增加kg |
|----------------|--------------|-----------------|--------------|--------------|---------|-----|-----------|----------|-----------|-----------------------|-----------------------|---------------------|---------------------|----|-----|-----|----|----|--------------------------------|--------------------------------|------------------------|--------------------|
| 40 | 1.46 | 22 | 2010 | 1400 | M16×1.5 | 22 | M18×1.5 | 48 | 20 | 42 | 66 | 54 | 80 | 19 | 32 | 190 | 8 | 12 | 8-M6 | 6-M8 | 3.9 | 0.111 |
| | 2 | 28 | | 1020 | M20×1.5 | 28 | | | | | | | | | | | | | | | 3.85 | 0.129 |
| 50 | 1.46 | 28 | 3140 | 2150 | M20×1.5 | 28 | M18×1.5 | 55 | 30 | 50 | 75 | 63.5 | 90 | 24 | 38 | 205 | 8 | 12 | 8-M6 | 6-M8 | 6.74 | 0.142 |
| | 2 | 36 | | 1510 | M27×2 | 36 | | | | | | | | | | | | | | | 6.76 | 0.174 |
| 63 | 1.46 | 36 | 4980 | 3350 | M27×2 | 36 | M27×2 | 70 | 38 | 60 | 90 | 76 | 108 | 29 | 45 | 224 | 10 | 12 | 8-M8 | 6-M10 | 8.5 | 0.234 |
| | 2 | 45 | | 2440 | M33×2 | 45 | | | | | | | | | | | | | | | 9.78 | 0.234 |
| 80 | 1.46 | 45 | 8040 | 5490 | M33×2 | 45 | M27×2 | 86 | 55 | 75 | 112 | 95 | 134 | 36 | 54 | 250 | 10 | 13 | 8-M10 | 6-M12 | 16.82 | 0.295 |
| | 2 | 56 | | 4100 | M42×2 | 56 | | | | | | | | | | | | | | | 18.3 | 0.36 |
| 90 | 1.46 | 50 | 10170 | 7030 | M42×2 | 56 | M27×2 | 100 | 55 | 80 | 132 | 108 | 158 | 36 | 55 | 270 | 10 | 17 | 8-M12 | 6-M16 | 19.3 | 0.41 |
| | 2 | 63 | | 5190 | M48×2 | 63 | | | | | | | | | | | | | | | 23.43 | 0.37 |
| 100 | 1.46 | 56 | 12560 | 8620 | M42×2 | 56 | M33×2 | 118 | 68 | 95 | 150 | 121 | 175 | 37 | 57 | 300 | 10 | 18 | 8-M12 | 8-M16 | 33.1 | 0.51 |
| | 2 | 70 | | 6400 | M48×2 | 63 | | | | | | | | | | | | | | | 31.6 | 0.48 |
| 110 | 1.46 | 63 | 15200 | 10200 | M48×2 | 63 | M33×2 | 132 | 60 | 95 | 165 | 133 | 195 | 37 | 57 | 310 | 10 | 22 | 8-M16 | 8-M16 | 41.48 | 0.52 |
| | 2 | 80 | | 7160 | M48×2 | 63 | | | | | | | | | | | | | | | 40 | 0.6 |
| 125 | 1.46 | 70 | 19600 | 13470 | M48×2 | 63 | M33×2 | 150 | 80 | 115 | 184 | 152 | 212 | 37 | 60 | 325 | 10 | 22 | 8-M16 | 8-M16 | 51 | 0.46 |
| | 2 | 90 | | 9450 | M64×3 | 85 | | | | | | | | | | | | | | | 52.48 | 0.6 |
| 140 | 1.46 | 80 | 24630 | 16580 | M48×2 | 63 | M42×2 | 165 | 95 | 132 | 200 | 168 | 230 | 37 | 62 | 335 | 10 | 22 | 8-M16 | 8-M16 | 64.8 | 0.79 |
| | 2 | 100 | | 12060 | M80×3 | 95 | | | | | | | | | | | | | | | 67 | 0.83 |
| 150 | 1.46 | 85 | 28270 | 19190 | M64×3 | 85 | M42×2 | 175 | 105 | 140 | 215 | 180 | 245 | 41 | 64 | 350 | 10 | 22 | 8-M16 | 8-M16 | 81.3 | 0.89 |
| | 2 | 105 | | 14420 | M80×3 | 95 | | | | | | | | | | | | | | | 83.43 | 0.95 |
| 160 | 1.46 | 90 | 32170 | 21990 | M64×3 | 85 | M42×2 | 190 | 110 | 150 | 230 | 194 | 265 | 41 | 66 | 370 | 10 | 26 | 8-M20 | 8-M20 | 133.29 | 1.04 |
| | 2 | 110 | | 16960 | M80×3 | 95 | | | | | | | | | | | | | | | 131.69 | 1.05 |
| 180 | 1.46 | 100 | 40710 | 28140 | M80×3 | 95 | M48×2 | 200 | 110 | 160 | 250 | 219 | 280 | 41 | 70 | 410 | 15 | 27 | 8-M20 | 8-M20 | 102.66 | 1.32 |
| | 2 | 125 | | 21080 | M80×3 | 95 | | | | | | | | | | | | | | | 130.94 | 1.36 |
| 200 | 1.46 | 110 | 50260 | 35060 | M80×3 | 95 | M48×2 | 215 | 120 | 170 | 280 | 245 | 310 | 45 | 75 | 450 | 15 | 27 | 8-M20 | 8-M20 | 181.75 | 1.53 |
| | 2 | 140 | | 25630 | M100×3 | 112 | | | | | | | | | | | | | | | 183.23 | 1.7 |
| 220 | 1.46 | 125 | 60820 | 41180 | M100×3 | 112 | M48×2 | 240 | 140 | 200 | 310 | 273 | 340 | 45 | 80 | 490 | 20 | 36 | 8-M24 | 12-M20 | 240 | 2.25 |
| | 2 | 160 | | 30630 | M100×3 | 112 | | | | | | | | | | | | | | | 259 | 2.33 |
| 250 | 1.46 | 140 | 78540 | 53900 | M100×3 | 112 | Φ 40 | 280 | 160 | 220 | 340 | 299 | 380 | 64 | 96 | 550 | 25 | 36 | 8-M24 | 12-M24 | 321 | 2.5 |
| | 2 | 180 | | 37820 | M125×4 | 125 | | | | | | | | | | | | | | | 406.58 | 2.5 |
| 280 | 1.46 | 160 | 98520 | 68330 | M125×4 | 125 | Φ 40 | 300 | 180 | 240 | 370 | 325 | 410 | 64 | 100 | 600 | 30 | 36 | 8-M24 | 12-M24 | 484.5 | 2.67 |
| | 2 | 200 | | 48250 | M125×4 | 125 | | | | | | | | | | | | | | | 534.3 | 2.87 |
| 320 | 1.46 | 180 | 128680 | 87960 | M125×4 | 125 | Φ 40 | 360 | 200 | 310 | 430 | 377 | 470 | 71 | 108 | 660 | 35 | 36 | 8-M24 | 16-M24 | 745.5 | 2.8 |
| | 2 | 220 | | 67850 | M160×4 | 160 | | | | | | | | | | | | | | | 797.2 | 3.1 |

注：1、选用液压缸时考虑管道阻力损失和机构中磨擦损失应将计算力增加10%。

2、D≤220油口用螺纹连接，D≥250油口用对开式法兰连接，表中尺寸为油口通径

小冶精通（天津）液压机械有限公司
头部圆法兰安装连接尺寸



表8

| | mm | | | | | | | | | | | | | | | | |
|----|-----|-----|------|------|-----|-----|-----|-----|-----|-----|-----|-----|-----|-----|-----|-----|-----|
| D | 40 | 50 | 63 | 80 | 90 | 100 | 110 | 125 | 140 | 150 | 160 | 180 | 200 | 220 | 250 | 280 | 320 |
| VD | 3 | 4 | 4 | 4 | 4 | 5 | 5 | 5 | 5 | 5 | 5 | 5 | 5 | 5 | 8 | 8 | 8 |
| ZB | 198 | 213 | 234 | 260 | 280 | 310 | 320 | 335 | 345 | 360 | 380 | 425 | 465 | 510 | 575 | 630 | 695 |
| FC | 106 | 126 | 145 | 165 | 195 | 210 | 230 | 250 | 265 | 280 | 300 | 325 | 355 | 390 | 430 | 470 | 530 |
| FB | 9 | 11 | 13.5 | 17.5 | 22 | 22 | 22 | 22 | 22 | 22 | 22 | 26 | 26 | 33 | 33 | 39 | 39 |
| ΦD | 126 | 150 | 175 | 200 | 240 | 255 | 275 | 295 | 310 | 325 | 345 | 375 | 405 | 445 | 485 | 525 | 595 |
| WC | 16 | 18 | 20 | 22 | 23 | 25 | 25 | 28 | 30 | 28 | 30 | 34 | 35 | 40 | 40 | 44 | 45 |

尾部圆法兰安装连接尺寸

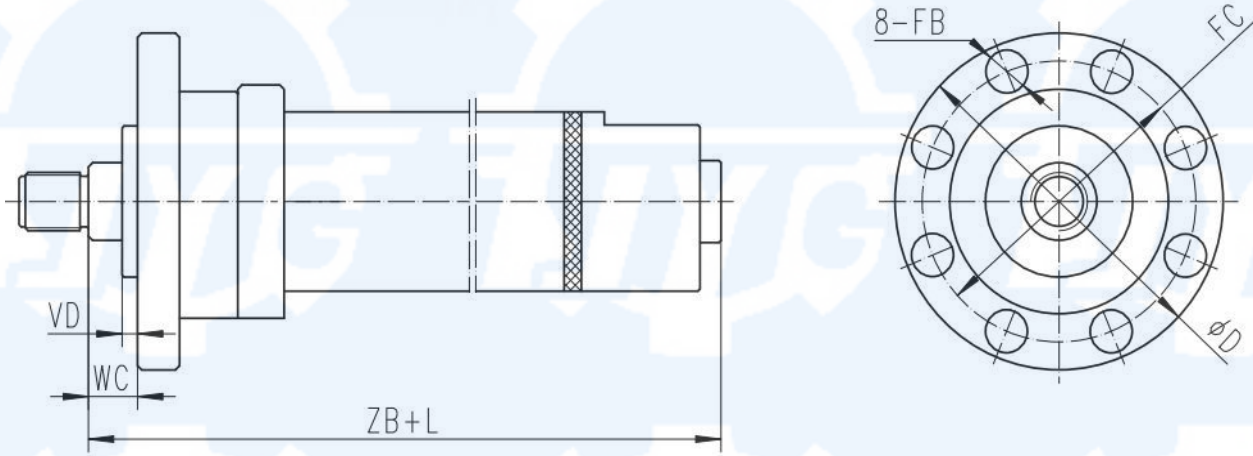

表9

| | mm | | | | | | | | | | | | | | | | |
|-----|-----|-----|------|------|-----|-----|-----|-----|-----|-----|-----|-----|-----|-----|-----|-----|-----|
| D | 40 | 50 | 63 | 80 | 90 | 100 | 110 | 125 | 140 | 150 | 160 | 180 | 200 | 220 | 250 | 280 | 320 |
| FC | 106 | 126 | 145 | 165 | 185 | 200 | 215 | 235 | 255 | 265 | 280 | 310 | 340 | 380 | 420 | 470 | 520 |
| ΦD | 126 | 150 | 175 | 200 | 228 | 245 | 260 | 280 | 300 | 310 | 325 | 360 | 390 | 435 | 475 | 525 | 585 |
| ΦBA | 20 | 30 | 38 | 55 | 55 | 68 | 60 | 80 | 95 | 105 | 110 | 110 | 120 | 140 | 160 | 180 | 200 |
| ZP | 206 | 225 | 249 | 282 | 302 | 332 | 342 | 357 | 370 | 386 | 406 | 450 | 490 | 535 | 606 | 660 | 723 |
| FB | 6 | 11 | 13.5 | 17.5 | 22 | 22 | 22 | 22 | 22 | 22 | 22 | 26 | 26 | 33 | 33 | 39 | 39 |

尾部单耳环安装连接尺寸图表

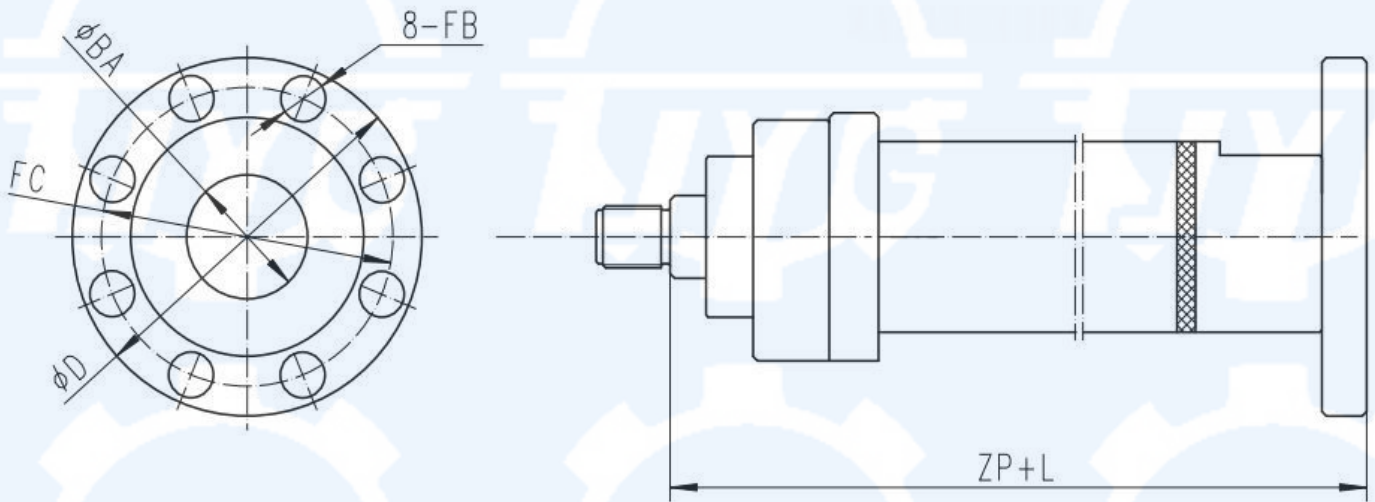

表12

| | mm | | | | | | | | | | | | | | | | |
|-----|-----|-----|-----|------|-----|------|------|-----|-----|-----|-----|-----|-----|-----|-----|-----|-----|
| D | 40 | 50 | 63 | 80 | 90 | 100 | 110 | 125 | 140 | 150 | 160 | 180 | 200 | 220 | 250 | 280 | 320 |
| ΦCD | 20 | 25 | 30 | 40 | 45 | 50 | 50 | 60 | 70 | 70 | 80 | 90 | 100 | 110 | 120 | 140 | 160 |
| MR | 27 | 32 | 38 | 47.5 | 54 | 60.5 | 66.5 | 76 | 84 | 90 | 97 | 110 | 123 | 137 | 150 | 163 | 189 |
| LT | 25 | 32 | 40 | 50 | 58 | 63 | 67 | 71 | 78 | 84 | 90 | 100 | 112 | 140 | 160 | 175 | 200 |
| ZJ | 190 | 205 | 224 | 250 | 270 | 300 | 310 | 325 | 335 | 350 | 370 | 410 | 450 | 490 | 550 | 600 | 660 |
| S | 18 | 22 | 26 | 30 | 35 | 38 | 38 | 50 | 58 | 58 | 62 | 68 | 72 | 72 | 88 | 90 | 92 |
| XO | 231 | 257 | 289 | 332 | 360 | 395 | 405 | 428 | 445 | 475 | 505 | 550 | 615 | 670 | 773 | 845 | 930 |

头部销轴安装连接尺寸

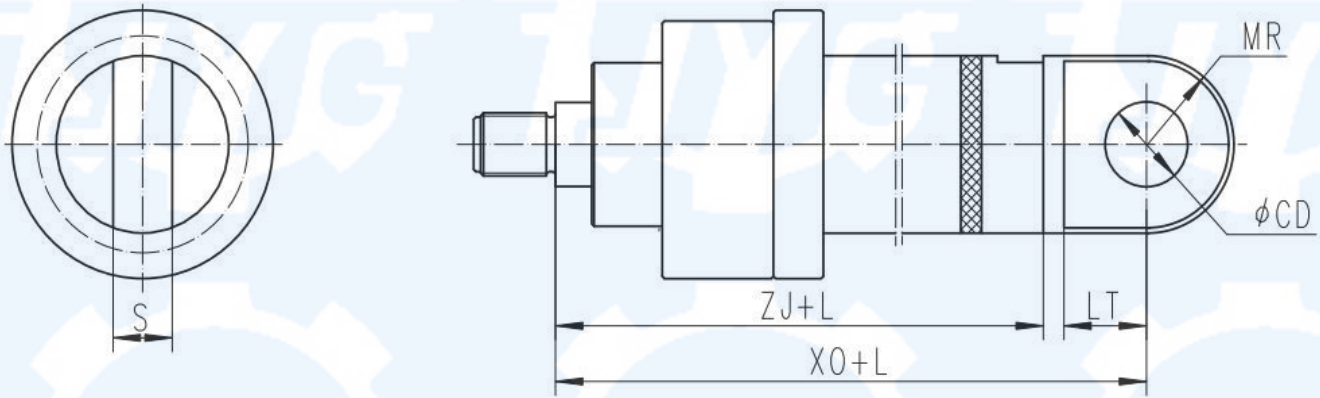

表13

| | mm | | | | | |
|-----|------|-----|-----|------|-----|------|
| D | 40 | 50 | 63 | 80 | 90 | 100 |
| ΦB | 48 | 55 | 70 | 86 | 100 | 118 |
| XG | 19.5 | 23 | 27 | 31.5 | 30 | 29.5 |
| ZB | 198 | 213 | 234 | 260 | 280 | 310 |
| ΦTD | 20 | 25 | 32 | 40 | 45 | 50 |
| TL | 16 | 20 | 25 | 32 | 36 | 40 |
| TC | 90 | 105 | 120 | 135 | 145 | 160 |
| T | 122 | 145 | 170 | 199 | 217 | 240 |

头部法兰安装连接尺寸

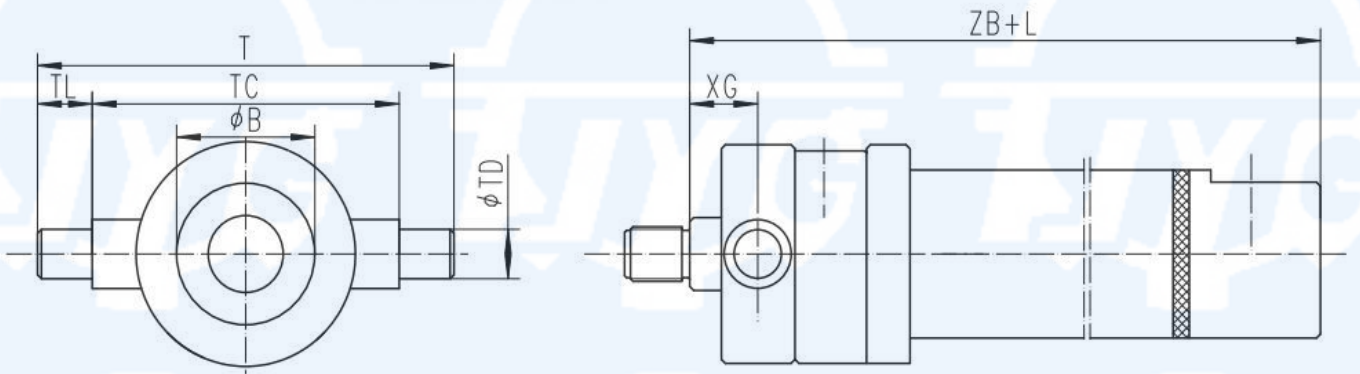

表10

mm

| | | | | | | | | |
|----------------|-----|-----|------|------|-----|-----|-----|-----|
| D | 40 | 50 | 63 | 80 | 90 | 100 | 110 | 125 |
| ZB | 198 | 213 | 234 | 260 | 280 | 310 | 320 | 335 |
| VD | 3 | 4 | 4 | 4 | 4 | 5 | 5 | 5 |
| W | 16 | 18 | 20 | 22 | 23 | 25 | 25 | 28 |
| FB | 9 | 11 | 13.5 | 17.5 | 22 | 22 | 22 | 22 |
| S ₁ | 95 | 115 | 132 | 155 | 170 | 190 | 215 | 224 |
| S ₂ | 115 | 140 | 160 | 190 | 210 | 230 | 255 | 265 |

尾部法兰安装连接尺寸

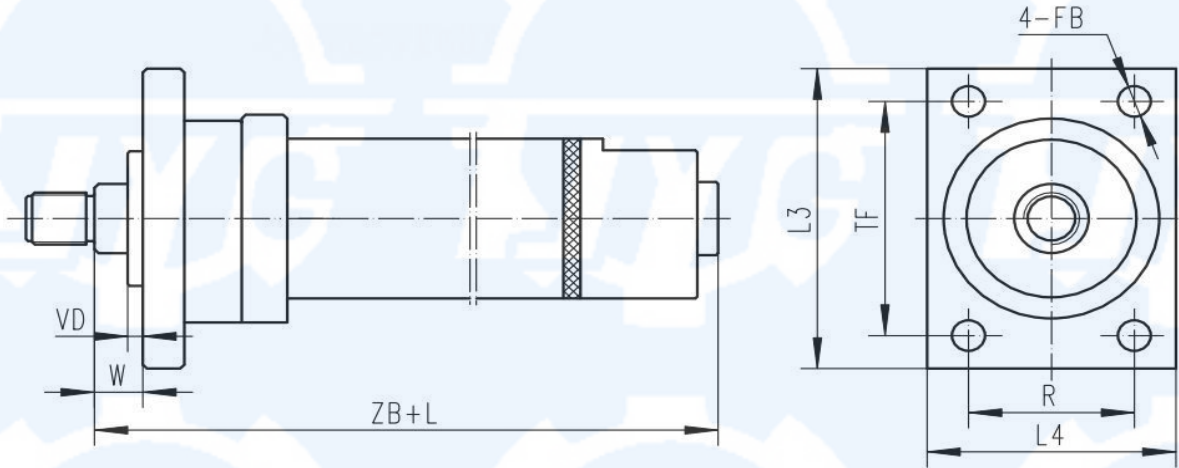
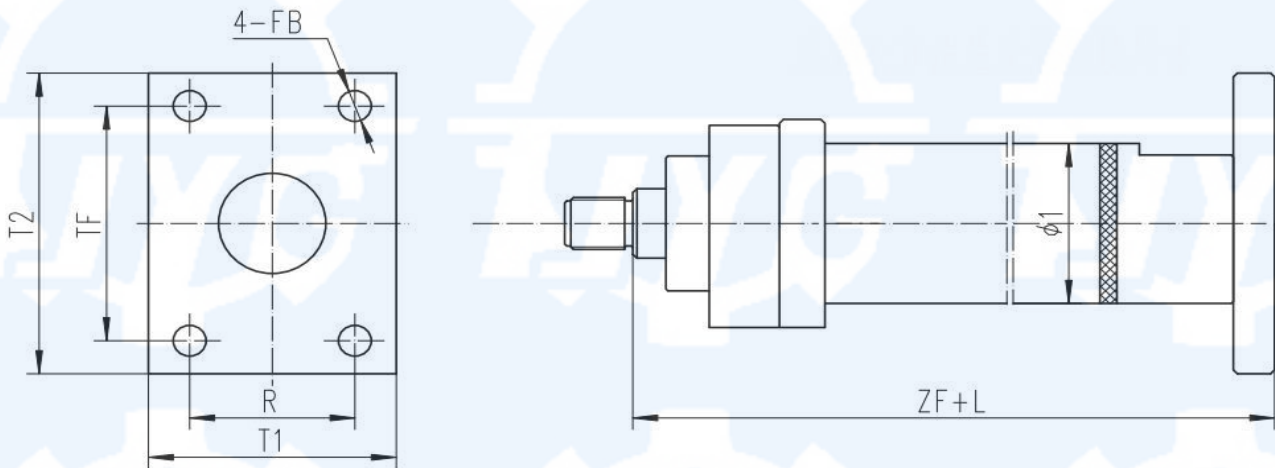

| | | | | | | | | |
|----------------|-----|-----|------|------|-----|-----|-----|-----|
| D | 40 | 50 | 63 | 80 | 90 | 100 | 110 | 125 |
| ZF | 206 | 225 | 249 | 282 | 302 | 332 | 342 | 357 |
| ΦBA | 20 | 30 | 38 | 55 | 55 | 68 | 60 | 80 |
| FB | 9 | 11 | 13.5 | 17.5 | 22 | 22 | 22 | 22 |
| S ₁ | 65 | 80 | 95 | 110 | 120 | 135 | 145 | 160 |
| S ₂ | 90 | 110 | 130 | 150 | 165 | 180 | 190 | 205 |

中间销轴安装连接尺寸



表14

mm

| | | | | | | | | | | | | | | | | | |
|-----|-----|-----|-----|-----|-----|-----|-----|-----|-----|-----|-----|-----|-----|-----|-----|-----|-----|
| D | 40 | 50 | 63 | 80 | 90 | 100 | 110 | 125 | 140 | 150 | 160 | 180 | 200 | 220 | 250 | 280 | 320 |
| ZB | 198 | 213 | 234 | 260 | 280 | 310 | 320 | 335 | 345 | 360 | 380 | 425 | 465 | 510 | 575 | 630 | 695 |
| ΦDT | 20 | 25 | 32 | 40 | 45 | 50 | 55 | 63 | 70 | 75 | 80 | 90 | 100 | 110 | 125 | 140 | 160 |
| TL | 16 | 20 | 25 | 32 | 36 | 40 | 45 | 50 | 55 | 60 | 63 | 70 | 80 | 90 | 100 | 110 | 125 |
| TM | 90 | 105 | 120 | 135 | 145 | 160 | 175 | 195 | 210 | 225 | 240 | 265 | 295 | 330 | 370 | 420 | 470 |
| T | 122 | 145 | 170 | 199 | 217 | 240 | 265 | 295 | 320 | 345 | 366 | 405 | 455 | 510 | 570 | 640 | 720 |

尾部销轴安装连接尺寸

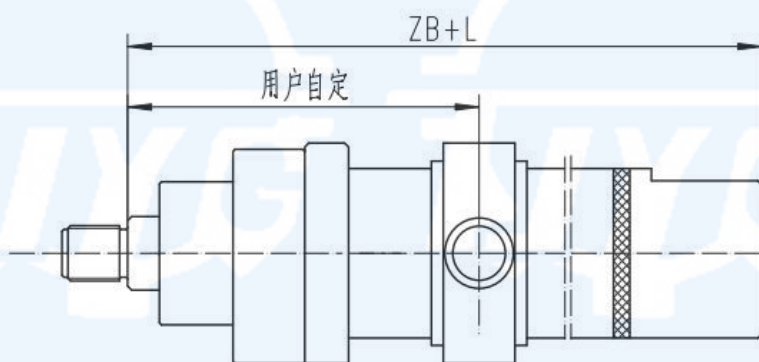
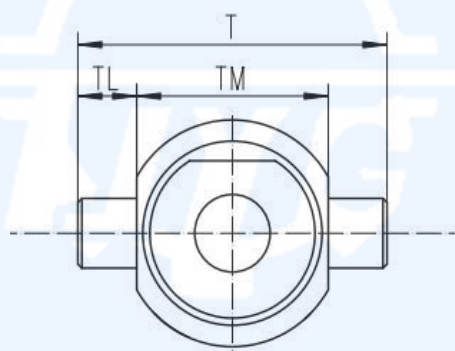

表15

mm

| | | | | | | | | | | | | | | | | | |
|-----|-------|-----|-----|-------|-----|-------|-----|-----|-------|-----|-------|-------|-------|-------|-----|-------|-------|
| D | 40 | 50 | 63 | 80 | 90 | 100 | 110 | 125 | 140 | 150 | 160 | 180 | 200 | 220 | 250 | 280 | 320 |
| XJ | 202.5 | 220 | 242 | 272.5 | 295 | 327.5 | 340 | 350 | 372.5 | 390 | 412.5 | 457.5 | 502.5 | 547.5 | 615 | 672.5 | 742.5 |
| ΦTD | 20 | 25 | 32 | 40 | 45 | 50 | 55 | 63 | 70 | 75 | 80 | 90 | 100 | 110 | 125 | 140 | 160 |
| TL | 16 | 20 | 25 | 32 | 36 | 40 | 45 | 50 | 55 | 60 | 63 | 70 | 80 | 90 | 100 | 110 | 125 |
| TC | 90 | 105 | 120 | 135 | 145 | 160 | 175 | 195 | 210 | 225 | 240 | 265 | 295 | 330 | 370 | 420 | 470 |
| T | 122 | 145 | 170 | 199 | 217 | 240 | 265 | 295 | 320 | 345 | 366 | 405 | 455 | 510 | 570 | 640 | 720 |
| ΦBA | 20 | 30 | 38 | 55 | 55 | 68 | 60 | 80 | 95 | 105 | 110 | 110 | 120 | 140 | 160 | 180 | 200 |

轴向脚架安装连接尺寸

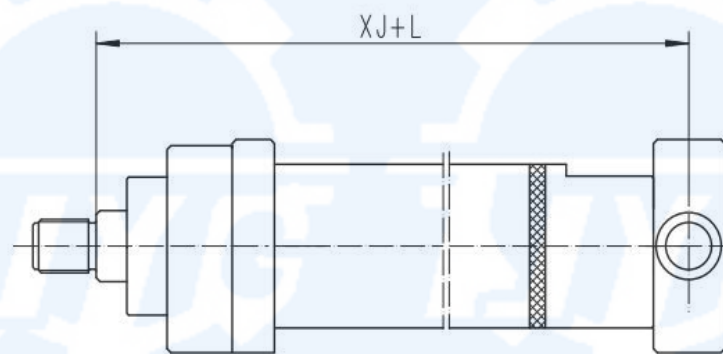
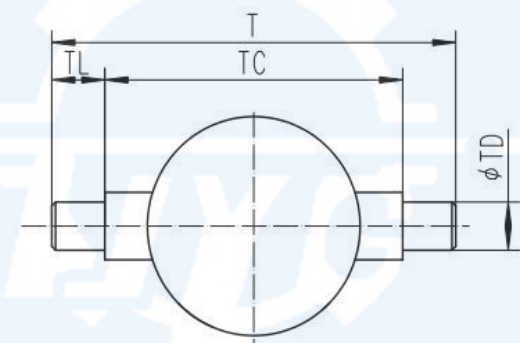
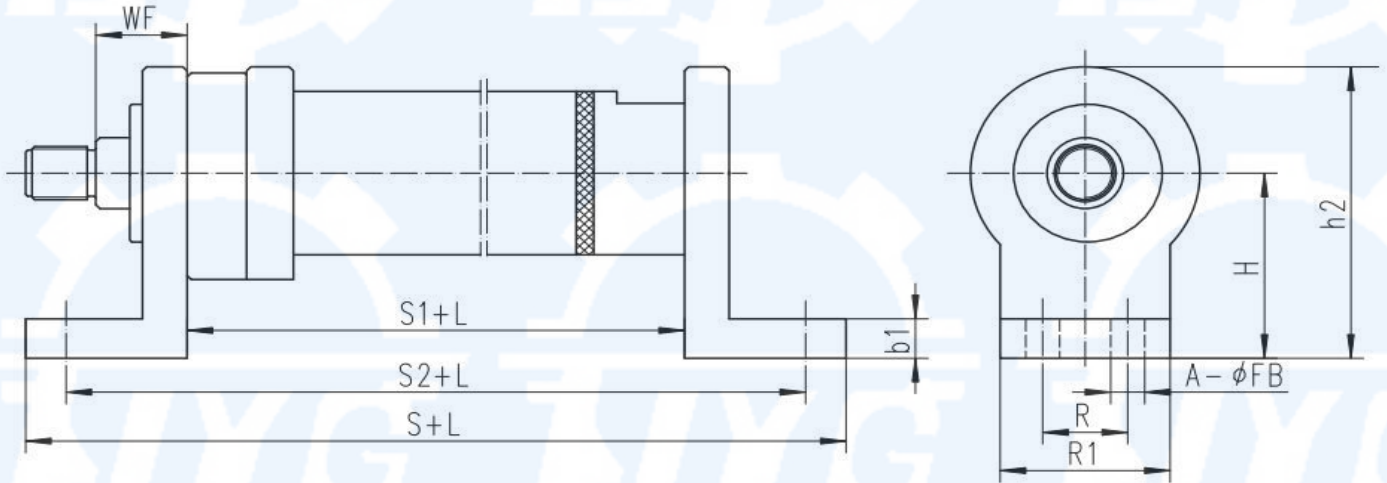

| | | | | | | | | | | | | | | | | | |
|-----|------|------|------|------|-----|-----|-----|-----|-----|-----|-----|-----|-----|-----|-----|-----|-----|
| D | 40 | 50 | 63 | 80 | 90 | 100 | 110 | 125 | 140 | 150 | 160 | 180 | 200 | 220 | 250 | 280 | 320 |
| S | 268 | 287 | 329 | 366 | 405 | 433 | 443 | 485 | 503 | 516 | 564 | 610 | 645 | 710 | 774 | 850 | 952 |
| S1 | 158 | 167 | 179 | 196 | 215 | 243 | 253 | 265 | 273 | 280 | 304 | 340 | 375 | 410 | 454 | 500 | 552 |
| S2 | 228 | 247 | 279 | 316 | 345 | 373 | 383 | 415 | 433 | 446 | 484 | 530 | 565 | 620 | 684 | 750 | 832 |
| WF | 32 | 38 | 45 | 54 | 55 | 57 | 57 | 60 | 62 | 64 | 66 | 70 | 75 | 80 | 96 | 100 | 108 |
| H | 60 | 70 | 85 | 105 | 116 | 125 | 135 | 150 | 155 | 165 | 175 | 190 | 205 | 225 | 255 | 275 | 310 |
| h1 | 18 | 22 | 28 | 35 | 35 | 35 | 35 | 35 | 40 | 40 | 40 | 45 | 45 | 50 | 60 | 65 | 70 |
| h2 | 100 | 115 | 140 | 172 | 195 | 213 | 233 | 256 | 270 | 290 | 305 | 330 | 360 | 395 | 445 | 480 | 545 |
| R | 45 | 55 | 70 | 90 | 100 | 125 | 145 | 155 | 170 | 185 | 190 | 200 | 220 | 250 | 300 | 320 | 370 |
| R1 | 80 | 90 | 110 | 134 | 158 | 175 | 195 | 212 | 230 | 245 | 260 | 280 | 310 | 340 | 380 | 410 | 470 |
| ΦFB | 13.5 | 13.5 | 17.5 | 17.5 | 22 | 22 | 22 | 26 | 26 | 26 | 33 | 33 | 33 | 39 | 39 | 45 | 52 |

小冶精通（天津）液压机械有限公司

头部耳环装配图

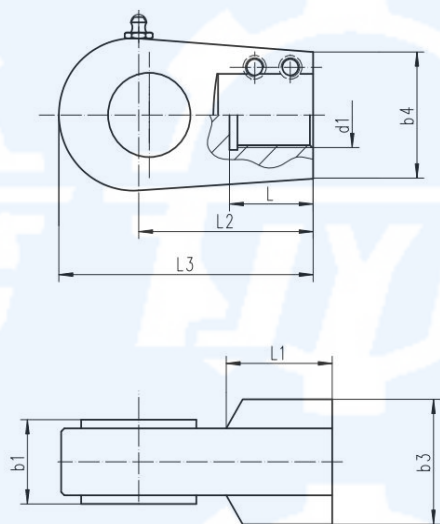

| D | 速比 i | ΦCD | d1 | b ₁ | b ₃ | b ₄ | L | L ₁ | L ₂ | L ₃ | R |
|-----|---------|-----|---------|----------------|----------------|----------------|-----|----------------|----------------|----------------|------|
| 40 | 1.46 | 20 | M16×1.5 | 18 | 26 | 36 | 23 | 34 | 60 | 88 | 25 |
| | 2 | | M20×1.5 | | 30 | 40 | 29 | 40 | 65 | 98 | 30 |
| 50 | 1.46 | 25 | M20×1.5 | 22 | 30 | 40 | 29 | 40 | 72 | 105 | 30 |
| | 2 | | M27×2 | | 37 | 47 | 37 | 48 | 80 | 118 | 35 |
| 63 | 1.46 | 30 | M27×2 | 26 | 37 | 47 | 37 | 48 | 80 | 118 | 35 |
| | 2 | | M33×2 | | 45 | 63 | 46 | 60 | 100 | 150 | 45 |
| 80 | 1.46 | 40 | M33×2 | 30 | 45 | 63 | 46 | 60 | 110 | 160 | 45 |
| | 2 | | M42×2 | | 56 | 72 | 57 | 70 | 120 | 182.5 | 57.7 |
| 90 | 1.46 | 45 | M42×2 | 35 | 56 | 66 | 57 | 70 | 128 | 181 | 50 |
| | 2 | | M48×2 | | 70 | 75 | 64 | 80 | 136 | 201 | 60 |
| 100 | 1.46 | 50 | M42×2 | 38 | 56 | 72 | 57 | 70 | 133 | 195.5 | 57.5 |
| | 2 | | M48×2 | | 70 | 78 | 64 | 80 | 143 | 213 | 65 |
| 110 | 1.46 | 50 | M48×2 | 38 | 70 | 75 | 64 | 80 | 147 | 212 | 60 |
| | 2 | | M48×2 | | 70 | 94 | 64 | 80 | 147 | 229 | 75 |
| 125 | 1.46 | 60 | M48×2 | 50 | 70 | 78 | 64 | 80 | 151 | 221 | 65 |
| | 2 | | M64×3 | | 90 | 104 | 87 | 105 | 176 | 271 | 85 |
| 140 | 1.46 | 70 | M48×2 | 58 | 70 | 94 | 64 | 80 | 158 | 240 | 75 |
| | 2 | | M80×3 | | 110 | 122 | 87 | 117 | 195 | 300 | 95 |
| 150 | 1.46 | 70 | M64×3 | 58 | 90 | 98 | 87 | 105 | 190 | 277 | 80 |
| | 2 | | M80×3 | | 110 | 116 | 87 | 117 | 200 | 287 | 80 |
| 160 | 1.46 | 80 | M64×3 | 62 | 90 | 104 | 87 | 105 | 195 | 290 | 85 |
| | 2 | | M80×3 | | 110 | 130 | 97 | 117 | 207 | 327 | 110 |
| 180 | 1.46 | 90 | M80×3 | 68 | 110 | 122 | 97 | 117 | 220 | 325 | 95 |
| | 2 | | M80×3 | | 110 | 140 | 97 | 117 | 220 | 350 | 120 |
| 200 | 1.46 | 100 | M80×3 | 72 | 110 | 130 | 97 | 117 | 230 | 350 | 110 |
| | 2 | | M100×3 | | 140 | 160 | 114 | 140 | 252 | 392 | 130 |
| 220 | 1.46 | 110 | M100×3 | 72 | 140 | 160 | 114 | 140 | 280 | 410 | 120 |
| | 2 | | M100×3 | | 140 | 160 | 114 | 140 | 280 | 440 | 130 |
| 250 | 1.46 | 120 | M100×3 | 88 | 140 | 160 | 114 | 140 | 300 | 440 | 130 |
| | 2 | | M125×4 | | 165 | 185 | 127 | 170 | 330 | 510 | 170 |
| 280 | 1.46 | 140 | M125×4 | 95 | 165 | 185 | 127 | 170 | 345 | 505 | 150 |
| | 2 | | M125×4 | | 165 | 200 | 127 | 170 | 345 | 505 | 150 |
| 320 | 1.46 | 160 | M125×4 | 105 | 165 | 185 | 127 | 170 | 370 | 505 | 170 |
| | 2 | | M160×4 | | 220 | 220 | 162 | 210 | 410 | 590 | 170 |

定 货 须 知

1. 冶标液压缸选用头部耳环时，应另行单独定货。
2. 耳环图号E包含E1、E2两种形式，E1为带关节轴承，E2为不带关节轴承（加轴套），安装尺寸不变。
3. 定货时应注明缸径D，杆径d